



Lighting System

Component Location Index

CAUTION:

- All SRS wiring harnesses are covered with yellow outer insulation.
- Before disconnecting any part of the SRS wire harness, install the short connectors (see page 23-409).
- Replace the entire affected SRS harness assembly if it has an open circuit or damaged wiring.

CONNECTOR "B" (Carries the SRS indicator signal)

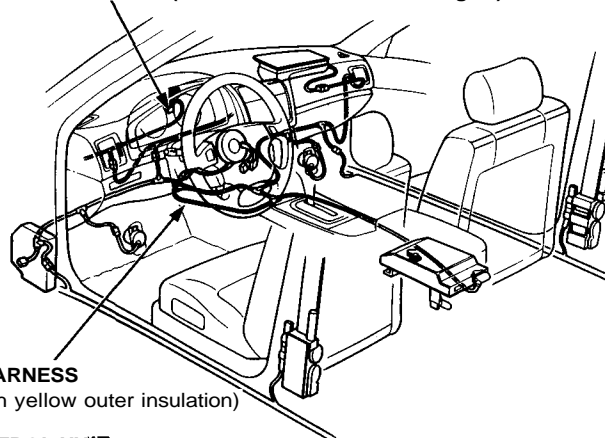

SRS MAIN HARNESS
(Covered with yellow outer insulation)

SECURITY CONTROL UNIT

Input Test, page 23-321
23-359 ('91), 23-357 ('92)

HIGH BEAM INDICATOR LIGHT
(In the gauge assembly)
Bulb Locations, page 23-135
23-139 ('91-'92)

DRL INDICATOR LIGHT (Canada)
(In the gauge assembly)
Bulb Locations, page 23-135
23-139 ('91-'92)

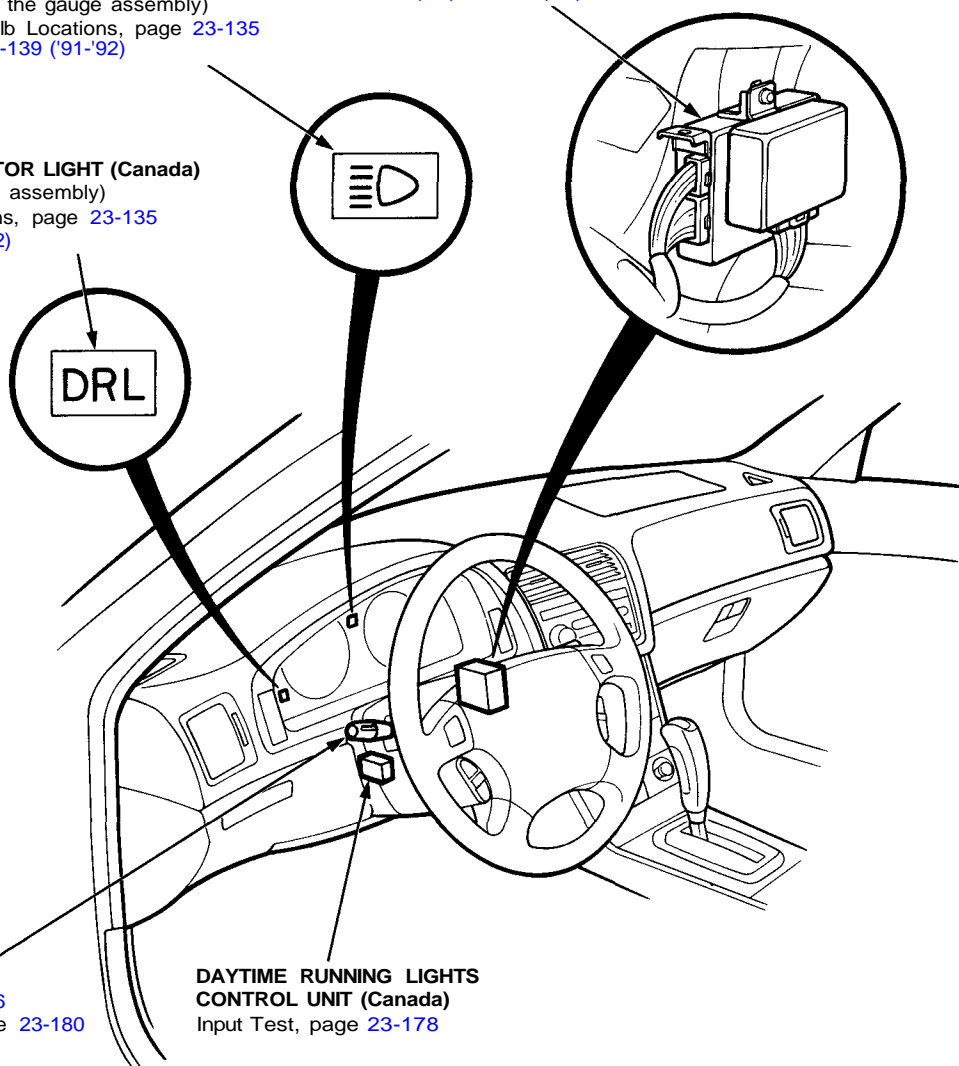

COMBINATION
LIGHT SWITCH
Test, page 23-176
Replacement, page 23-180

DAYTIME RUNNING LIGHTS
CONTROL UNIT (Canada)
Input Test, page 23-178

(cont'd)

Lighting System

Component Location Index (cont'd)

